

'K 4'

450 sqmm / 52 mmØ

CABLE CUTTER

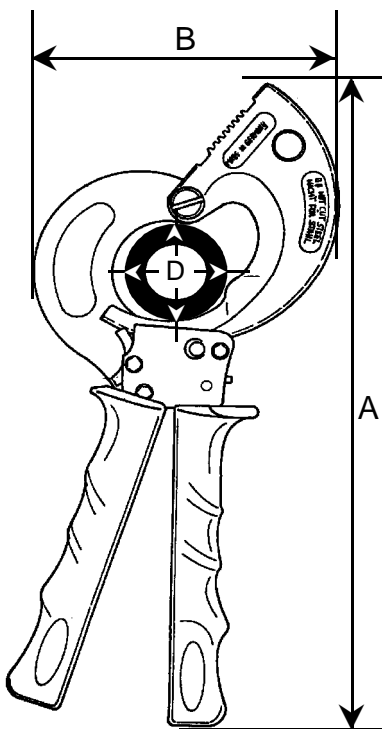

MAIN DATA

Measures (apprx.):

Length A: 320 mm
 Width B: 145 mm
 CableØ D: 52 mm
 Weight: 1.04 kg

Grips:

Polypropylen (PP), sev. cadmium-free colors

Surfaces:

mainly blackened

Other material:

all moving parts made from high grade steels, specially heat treated.

SPAREPARTS

The parts shown in the exploded drawing and the list are easily changeable if the guides in our leaflet 'Info K4' are being observed. This will be mailed at your request.

Further our Service will be happy to help you in case of repairs or sparepart needs.

BEKU-APPARATEBAU
 Quitzowstraße 24-26
 10559 Berlin

Tel: +49-30-396 06 90
 Fax: +49-30-396 50 97

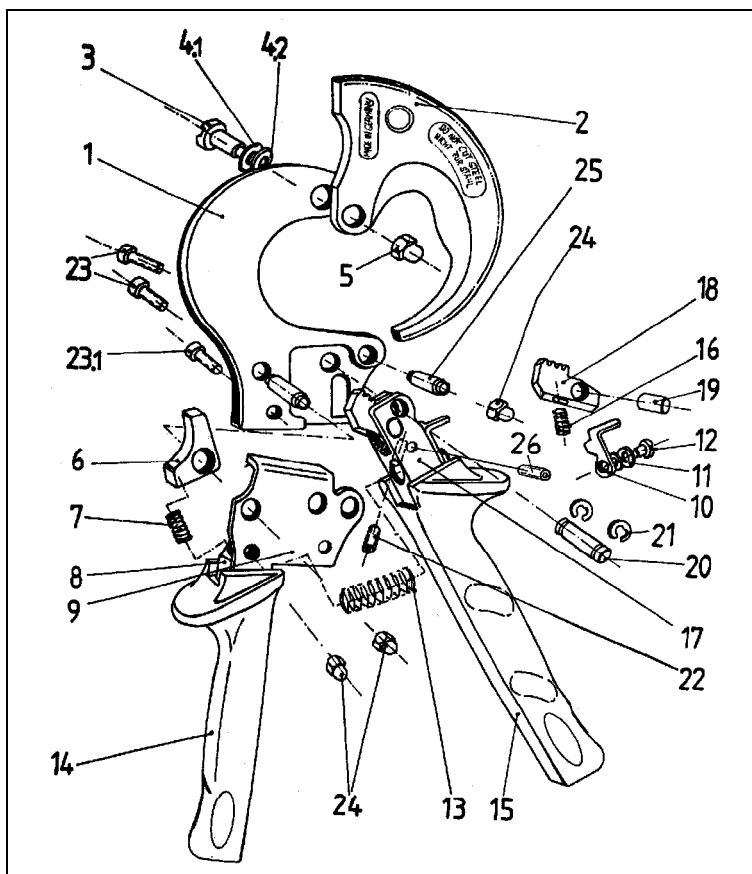

Part No.	Each per cutter	Description	Order No.
1	1	Fixed Blade	44.100
2	1	Moveable Blade	44.101
3	1	Pinscrew	44.102
4.1	1	Platespring	44.103
4.2	1	Adjustment Washer	44.104
5	1	Headed Nut M6	44.105
6	1	Holding Ratchet	44.106
7	1	Spring	44.107
9	1	Cover Plate complete w/ tube holder	44.109
10	1	Locking Device	44.110
11	2	Platespring 4,2 mmØ	44.111
12	1	Pinscrew	44.112
13	1	Spring	44.113
14	1	Grip, fixed handle	44.114
15	1	Grip, moveable handle	44.115
16	1	Spring	44.116
17	1	Moveable Handle	44.117
18	1	Ratchet	44.118
19	1	Axle 6,5 mmØ	44.119
20	1	Bolt	44.120
21	2	Circlip for part 20	44.121
22	1	Adjustment Screw for part 18	44.122
23	3	Assembling Screw M5x27	44.123
24	3	Headed Nut M5	44.124
25	3	Distance Case	44.125
26	1	Locking Screw	44.126